

SAN JUAN-CHAMA DRINKING WATER PROJECT
TRANSMISSION LINE NO. 2 PHASE 2 CHARLES WELL PIPELINE CONSTRUCTION
MOVING TO HAINES AVENUE STARTING TUESDAY, JANUARY 30, 2007
Securing Our Future Water Supply

NOTE: All work is scheduled weather permitting and is subject to change without notice.

Starting on **Tuesday, January 30, 2007**, crews will relocate a 6" waterline on **Haines Avenue** between **Cardenas Drive** and **Valencia Drive** as part of the San Juan-Chama Drinking Water Project No. 2, Phase 2 – Charles Wells Pipeline.

The **6" waterline relocation** is expected to last for **approximately one week** and is in preparation for the large diameter pipeline installation on Haines Ave. **Completion for the large diameter pipeline installation on Haines Ave between Cardenas Drive and Valencia Drive is expected to last through March 2, 2007.**

Haines will be closed to through traffic from just east of Alvarado to just west of San Pedro Drive. ACCESS WILL BE MAINTAINED TO ALL LOCAL RESIDENCES. Motorists can use **Hannett, Alvarado** and **Indian School Road** as alternate routes.

Traffic on **San Pedro Drive south of Menaul Blvd.,** will continue to be shifted to the southbound lanes with one lane of traffic open in each direction as large diameter pipeline is installed in the eastside of the roadway. **ACCESS WILL BE MAINTAINED TO ALL LOCAL BUSINESSES.** This phase of work is expected to last through early April 2007. **Work hours will be 7 a.m.-7 p.m. Monday-Friday and 8 a.m.-5 p.m. Saturday, although crews may occasionally work longer hours if needed.**

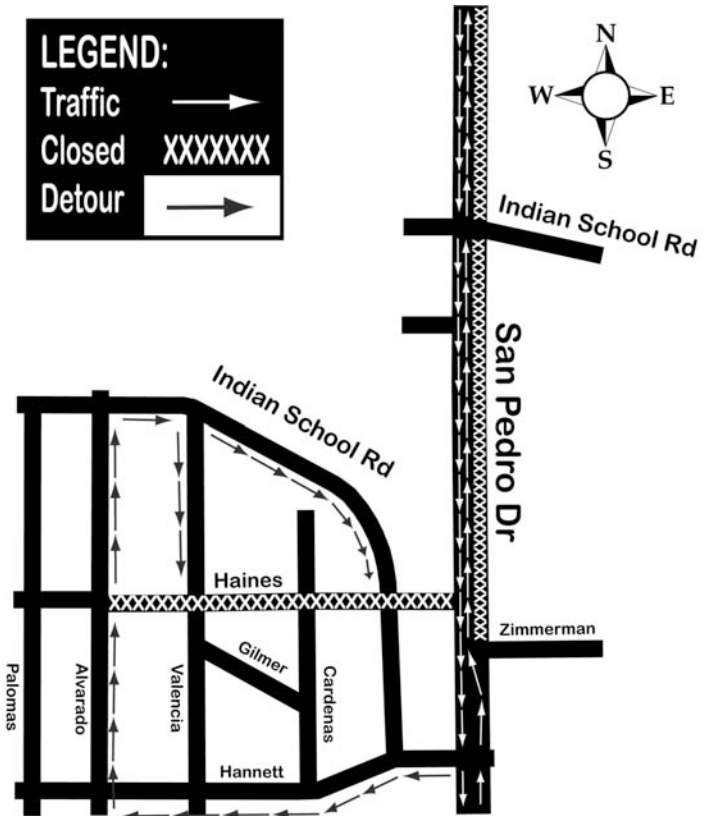

IMPORTANT NOTICE: CREWS MAY ASK TO VIDEOTAPE YOUR PROPERTY

A representative from ERS, the contractor, may contact you at least three weeks before the time construction crews are scheduled to be in a "work zone" that includes your property to request permission to videotape exterior and interior structures. Contact **Pete Dobbs** (see numbers below) for more information.

If you have questions or issues at the construction site, please contact:

Pete Dobbs, Community Liaison, ERS, Office 352-0507; Cell 553-5925.

If you have other questions or issues, please contact: Patti Watson, 269-9691 (cell) or 293-2000.office; Shannon Zamarrón, 306-8452 (cell) or 293-2000 office.

PLEASE KEEP IN TOUCH!

If you would like more information about the project, or would like to be added to our San Juan-Chama Drinking Water Project Information List, call **293-2000** or e-mail pattiw@cooneywatson.com. Or, visit our website at www.sjcdinkingwater.org.