

SAN JUAN-CHAMA DRINKING WATER PROJECT

Securing Our Future Water Supply

NOTE: All work is scheduled weather permitting and is subject to change without notice.

EAST VALLEY PIPELINE CONSTRUCTION UPDATE!!! CREWS TO LAY PIPELINE ON 2ND STREET IN MID-FEBRUARY CANDELARIA WORK TO WRAP UP BY EARLY MARCH

Crews have completed the bore (tunnel) under the intersection of Candelaria Road and 2nd Street. In **mid-February**, AUI, the contractor, expects to continue laying 72" pipeline on **2nd Street** working from north to south. **Work hours will generally be Monday-Saturday from 7 a.m. - 7 p.m.**, although crews may occasionally work longer hours if needed.

Traffic along 2nd Street will be shifted in phases. Barriers will be removed as work progresses south. All motorists should expect occasional delays and can use **Menaul Blvd. NE** or **4th Street NW** as alternate routes.

During Phase 1, (see map to right) **one lane of southbound traffic and two lanes of northbound traffic** will be maintained on **2nd Street**. **Left turns will be permitted from 2nd to Candelaria**, however, the turn lane will be temporarily shortened. This phase of construction is expected last from **mid-February** through **mid March 2007**.

During Phase 2, (see map to right) traffic will be shifted to the east side of **2nd Street** between **Shropshire Place** and south of **Mildred** with at least one lane of traffic in each direction. **NO left turns** will be permitted on **Shropshire Place**. This phase of construction is expected to last from the **end of February 2007** through the **early March 2007**.

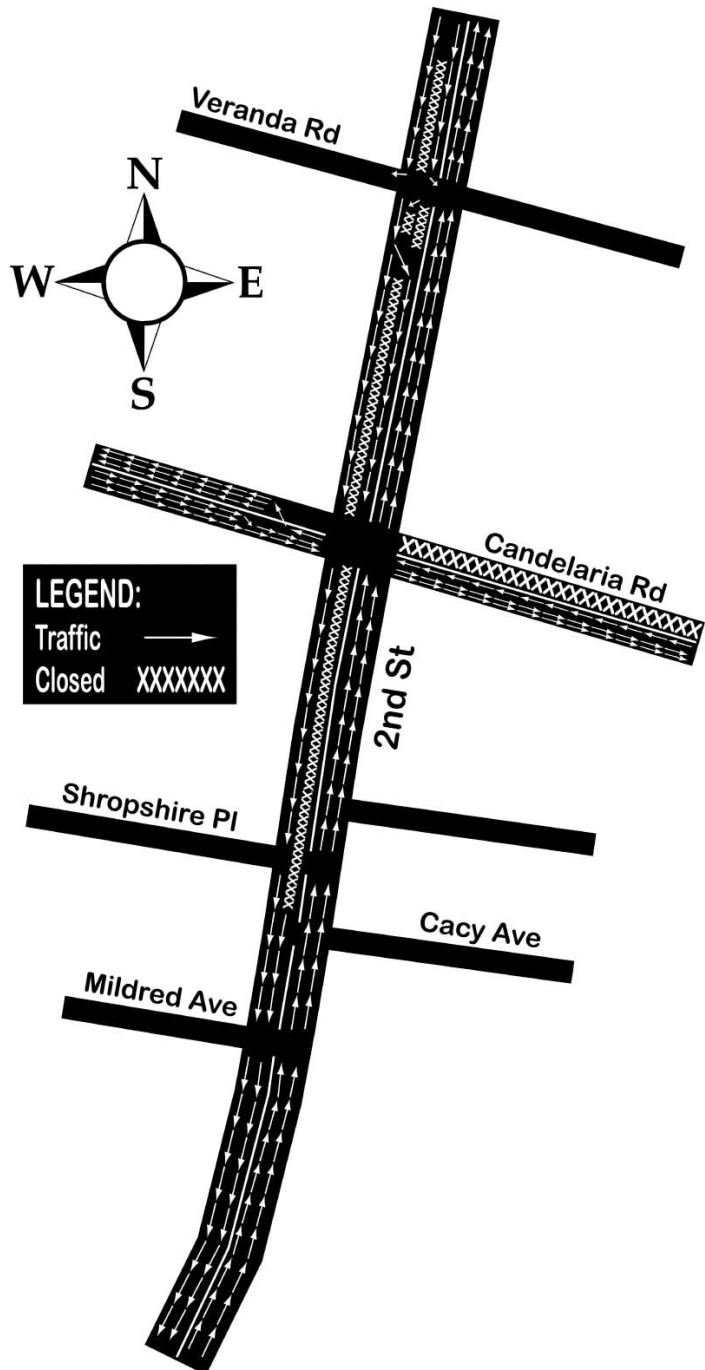

(OVER)

During Phase 3, (see map below), both lanes on the west side of 2nd Street will be closed between Shropshire Place and south of Mildred, with all traffic shifted to the east side of 2nd Street with one lane open each in direction. This phase will last from **early March 2007** through the **end of March 2007**.

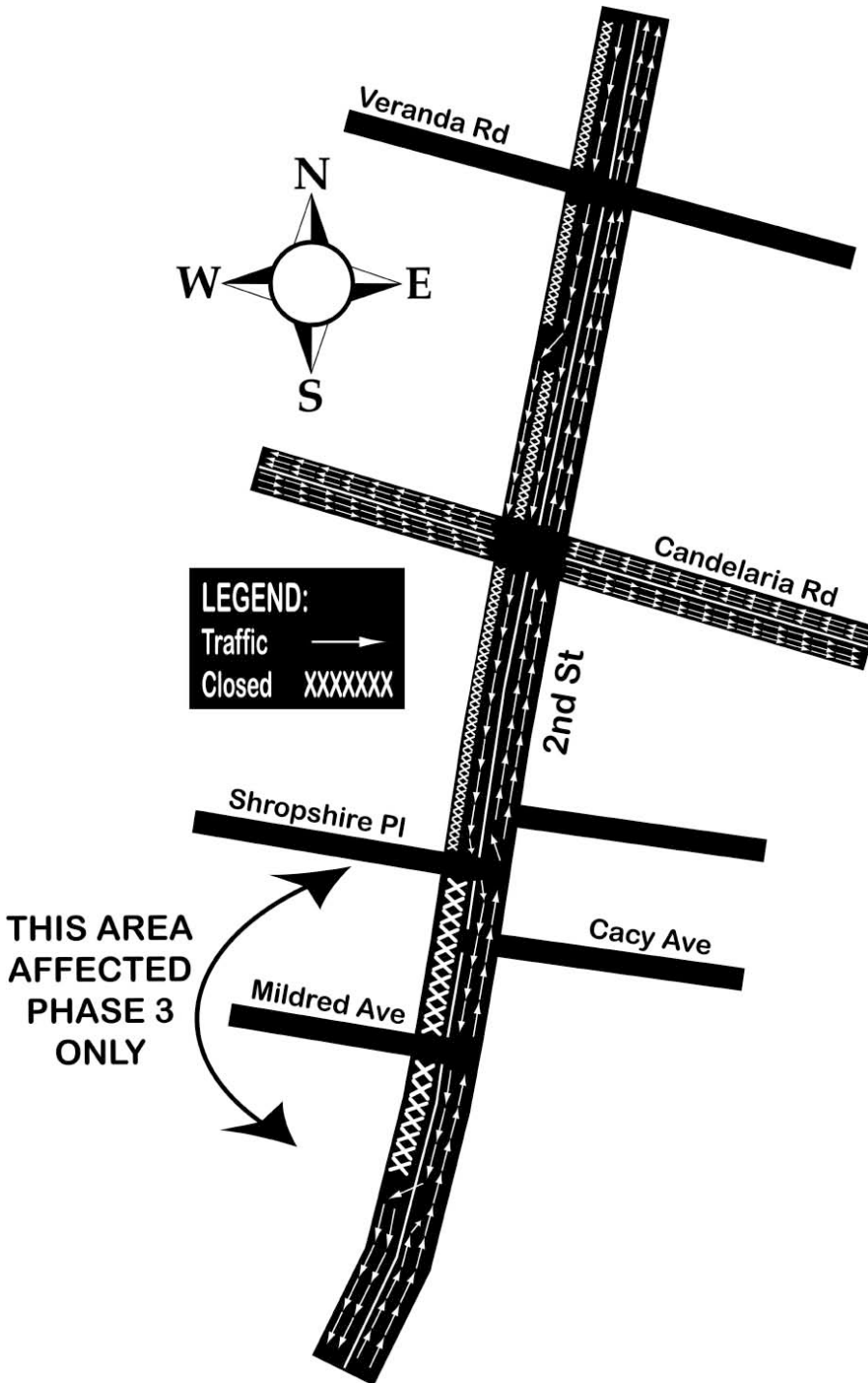

NOTE: Paving, concrete and gutter work on Candelaria are continuing and are expected to wrap up in late February or early March. Until then, barricades must remain on Candelaria east and west of the railroad tracks for the safety of motorists. Barricades east of Edith will be removed by Monday, February 12, 2007.

ACCESS WILL BE MAINTAINED TO ALL RESIDENCES AND BUSINESSES.

Please Keep In Touch!

If you would like more information about this project, have questions, or would like to be added to our drinking water project information list, call **242-ROAD (242-7623)** or call Patti Watson or Shannon Zamarrón at 293-2000 or e-mail

pattiw@cooneywatson.com.

Or, visit the project's website at

www.sjcdinkingwater.org.